



ACTION 2600 MP6

HSK-A100

Rapid feeds 40 m/min.

Pallet dimensions 800x800/800x1,000

1,000x1,000/1,000x1,250

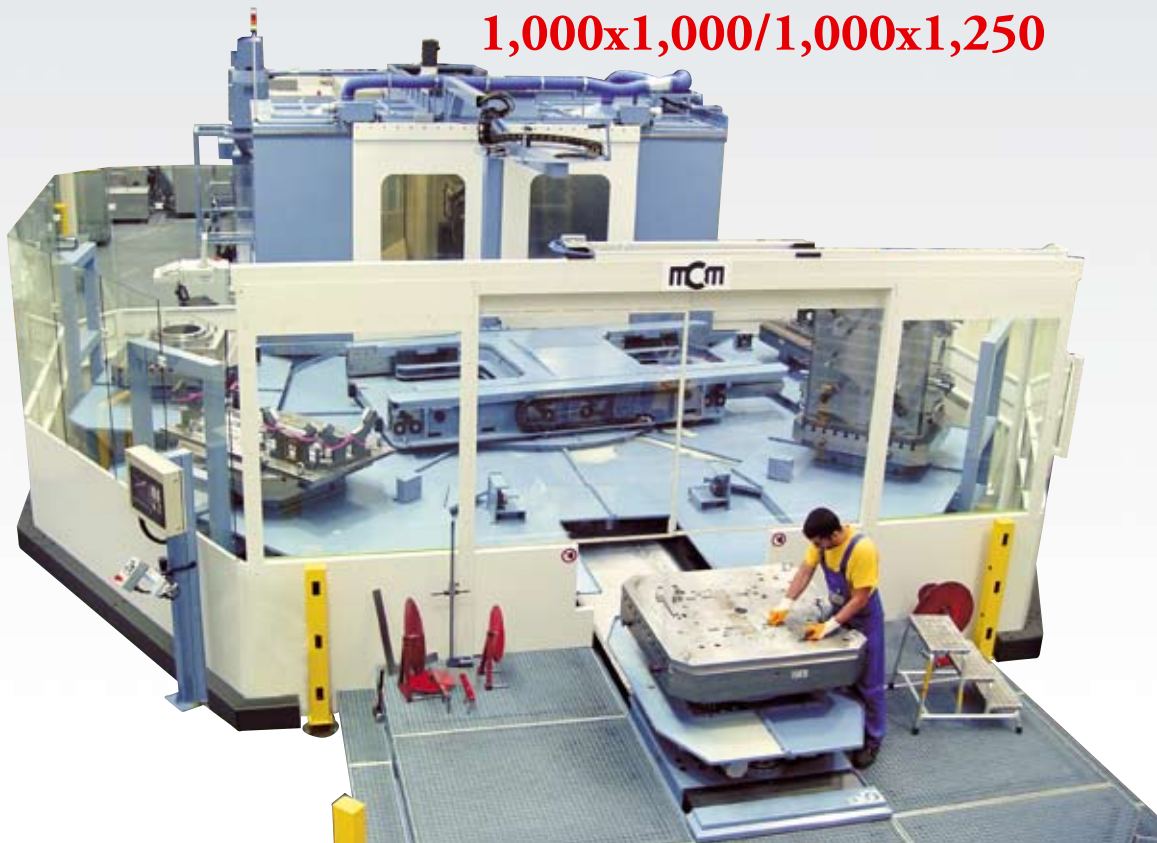

Tool changing time

2 s

Number of tools

95-999

Tool regeneration+washing+tool check

10 s

Spindle speed

14,000/8,000/6,000 rpm

Continuous rotary table

Linear axes measuring system with pressurized optical scales

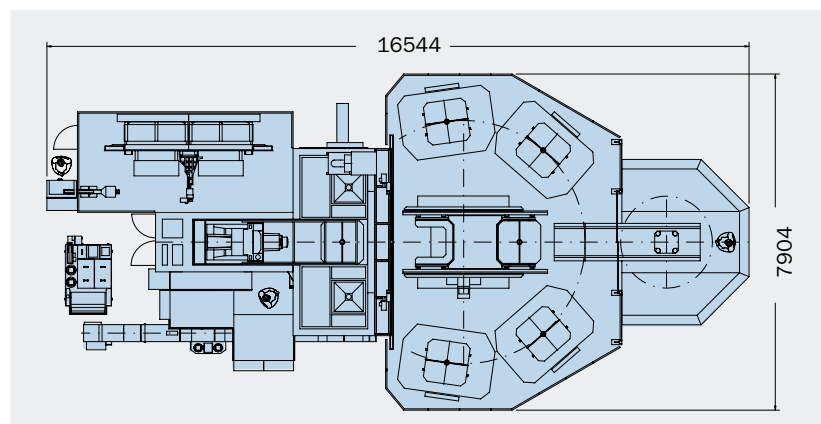



ACTION FMC-FMS Super Tool

ACTION 2600

HSK-A100

Pallet 800x800/800x1,000/1,000x1,000/1,000x1,250



Shared mirror type tool magazine

Super Tool

Number of tools HSK-A100

291-999

Tools regeneration with buffer

+ washing + tool check

12 s

Number of pallets

14-100

Pallets automation on 3 different levels

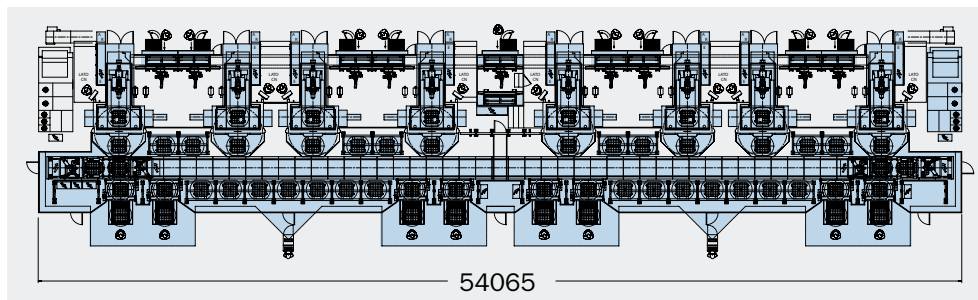

MACHINING CENTERS MANUFACTURING

MCM Spa

I-29020 Vigolzone (PC)
Viale F. e G. Celaschi, 19
Tel. ++39 0523 879901
Fax ++39 0523 879130
E-mail: divcomm@mcmspa.it
http: www.mcmspa.it

MCM FRANCE Sarl

F-91600 Savigny sur Orge
6 Av. du Garigliano
Tel. 01-69-21-21-00
Fax 01-69-24-10-34
E-mail: mcm@mcm-france.com

MCM VERTRIEBS GmbH

DEUTSCHLAND
D-65189 Wiesbaden Humboldtstraße, 13
Tel. 0611-372747
Fax 0611-372745
E-mail: rebecchi@t-online.de

MCM CANADA

2311- 29th Ave. LAVAL WEST, QC
H7R 3L4 CANADA
Phone (450) 627 1414
Fax (450) 627 7336
E-mail: astefanoni@sympatico.ca

MCM USA Inc.

34525 Melinz Parkway, Suite 208-C
Eastlake, OH 44095 - U.S.A.
Phone (440) 9181415
Fax (440) 9180776
Toll free 877 MCM 5999