



ACTION 2600 MP6

HSK-A100

Rapidi 40 m/min

Dimensione pallet 800x800 - 800x1000

1000x1000 - 1000x1250

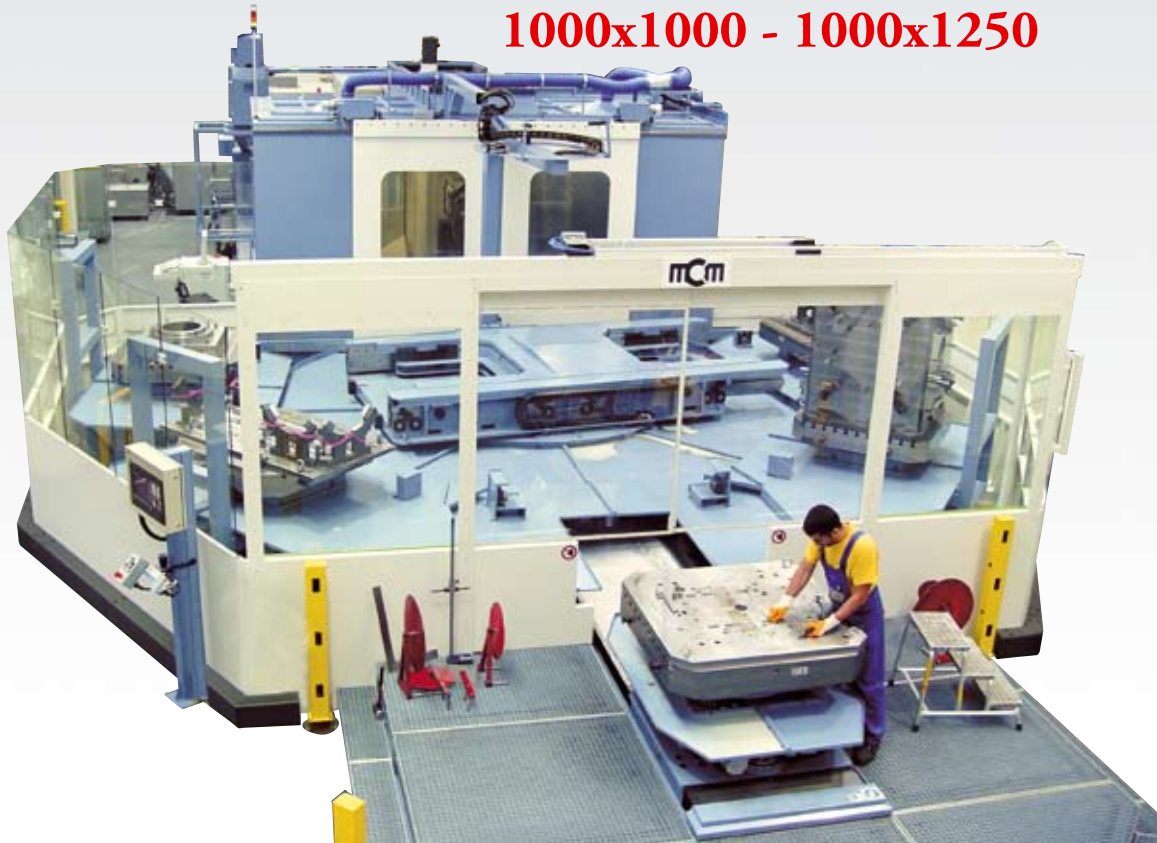

Tempo di cambio utensile	2 s
N° utensili HSK-A100	95-999
Rigenerazione + lavaggio + integrità	10 s
Velocità mandrino	14.000/8.000/6.000
Tavola girevole continua	
Rilevamenti assi lineari con righe ottiche pressurizzate	

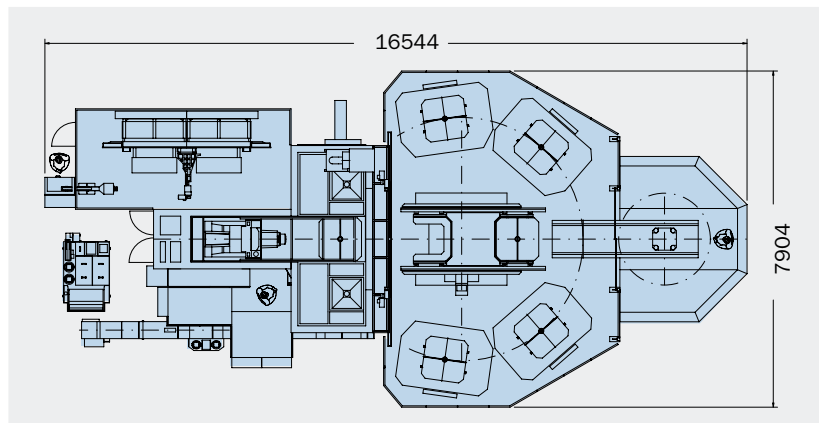



ACTION FMC-FMS Super Tool

ACTION 2600

HSK-A100

Pallet 800x800-800x1000-1000x1000-1000x1250



Magazzino utensili mirror in condivisione

Super Tool

N° utensili HSK-A100

291-999

Rigenerazione utensile con buffer

+ lavaggio + integrità

12 s

N° pallet

14-100

Automazione pallet su 1-2-3 livelli

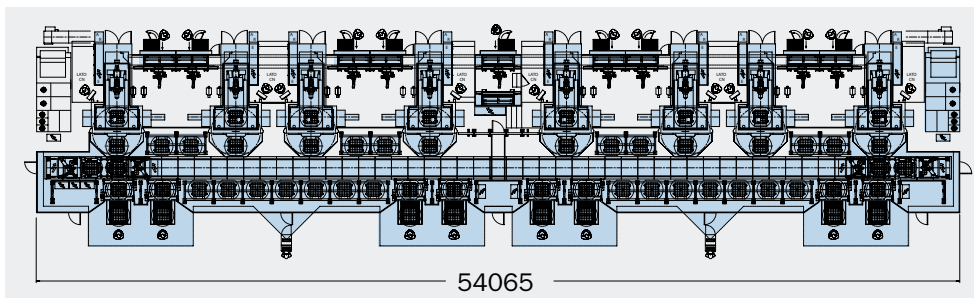

MACHINING CENTERS MANUFACTURING

MCM Spa

I-29020 Vigolzone (PC)
Viale F. e G. Celaschi, 19
Tel. ++39 0523 879901
Fax ++39 0523 879130
E-mail: divcomm@mcmspa.it
http: www.mcmspa.it

MCM FRANCE Sarl

F-91600 Savigny sur Orge
6 Av. du Garigliano
Tel. 01-69-21-21-00
Fax 01-69-24-10-34
E-mail: mcm@mcm-france.com

**MCM VERTRIEBS GmbH
DEUTSCHLAND**

D-65189 Wiesbaden Humboldtstraße, 13
Tel. 0611-372747
Fax 0611-372745
E-mail: rebecchi@t-online.de

MCM CANADA

2311- 29th Ave. LAVAL WEST, QC
H7R 3L4 CANADA
Phone (450) 627 1414
Fax (450) 627 7336
E-mail: astefanoni@sympatico.ca

MCM USA Inc.

34525 Melinz Parkway, Suite 208-C
Eastlake, OH 44095 - U.S.A.
Phone (440) 9181415
Fax (440) 9180776
Toll free 877 MCM 5999