

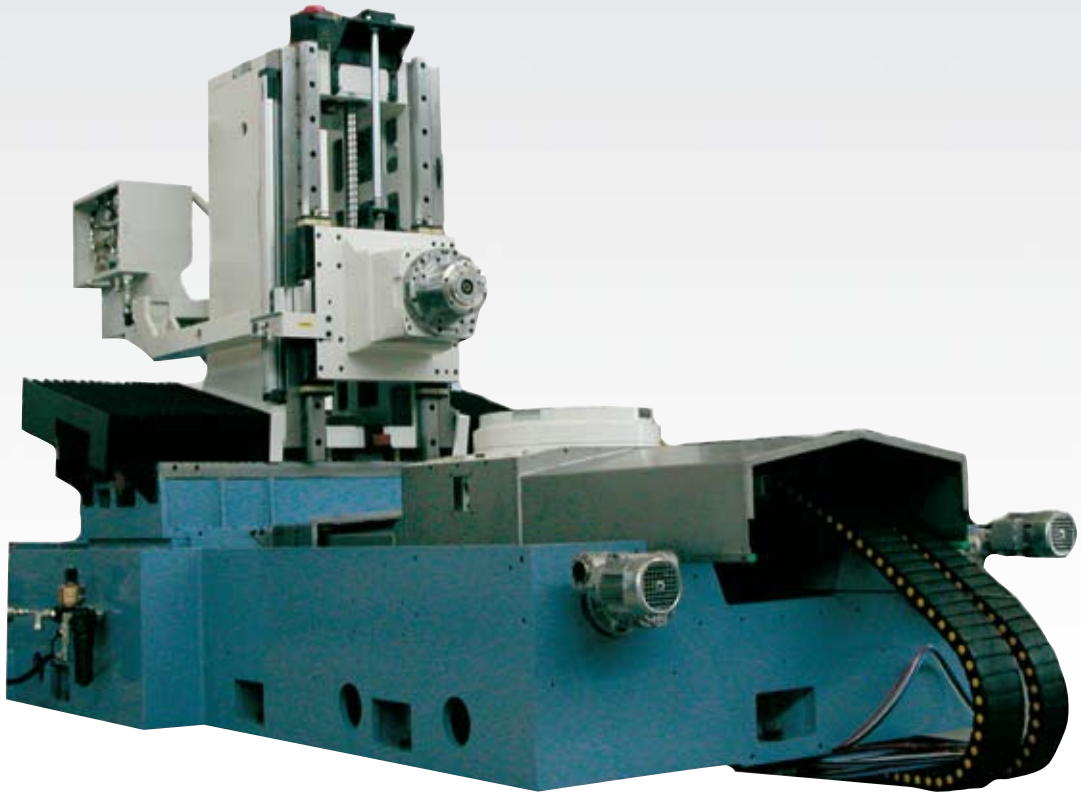

CLOCK 700

HSK-A100 / HSK-A63
Rapid feeds 90 m/min.
Pallet dimensions 500x500



Tool changing time	0.6 s
Number of tools HSK-A100	95 - 999
Tool regeneration + washing + tool check	10 s
Spindle speed	14,000/24,000 rpm
Chips size	4,000 cm ³ /min. for Aluminium 700 cm ³ /min. for Steel
Continuous rotary table	
Linear axes measuring system with pressurized optical scales	



CLOCK 700

TECHNICAL FEATURES

WORKING AREA

Longitudinal X axis	mm	700
Vertical Y axis	mm	650
Transversal Z axis	mm	700
Rapid feeds	m/min	90
Axes thrust	daN	2,000
Spindle tip-Y pallet distance	mm	100
Spindle tip-Z pallet distance	mm	100
Linear axes measuring system		pressurized Heidenhain optical scales
Rotating axes measuring system		pressurized Heidenhain encoders
AC axes servomotor drive with digital adjustment		

POSITIONING PRECISION IN ACCORDANCE WITH VDI/DGQ 3441 SPECIFICATIONS

Linear axes (XYZ)

Positioning precision (Pa)	µm	6
Repeatability precision (Ps Med)	µm	3

Rotating axes (B)

Positioning precision (Pa)	arcsec	6
Repeatability precision (Ps med)	arcsec	4

SPINDLE TYPE HSK-A63

Tool taper (DIN69893-1)	type	HSK-A63
Rotating speed	rpm	15,000/24,000
Power	kW	60/50
Max torque	Nm	214/150
Front bearing diameter	mm	85

SPINDLE TYPE HSK-A100

Tool taper (DIN69893-1)	type	HSK-A100
Rotating speed	rpm	14,000
Power	kW	65
Max torque	Nm	400
Front bearing diameter	mm	110

TOOL CHANGE

Standard features		
Wheel/rack type tool magazine capacity	n.	125/1367 HSK-A63
Wheel/rack type tool magazine capacity	n.	95/999 HSK-A100
Max. tool length	mm	350
Max tool weight	kg	10/25
Chip to chip tool changing time	s	4
Max. tool diameter	mm	200/300
Adjacent tools max. diameter	mm	65/100

PALLET CHANGER

Pallet changing time	s	6
Number of pallet	n.	2
Pallet dimensions	mm	500x500
Overall rotating diameter	mm	800
Max. load for pallet	kg	400

CONTINUOUS ROTATING TABLE

Positions	n.	3,600,000
Speed rotation	rpm	65

CHIPS CONVEYOR

Scraper type

COOLANT SYSTEM

750 liters tank with self-cleaning filter

TOTAL WEIGHT (Two pallets version)

kg 16,500

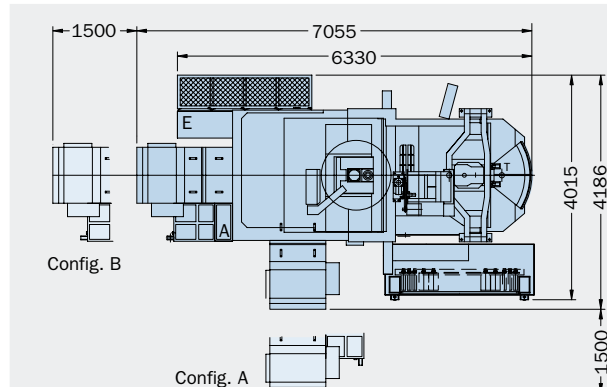
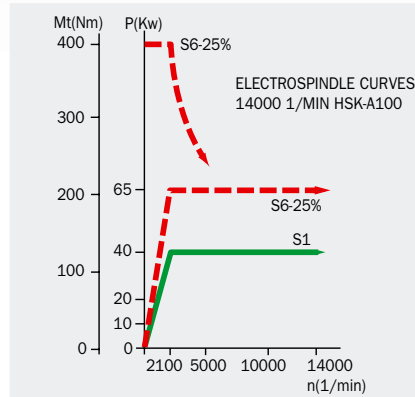
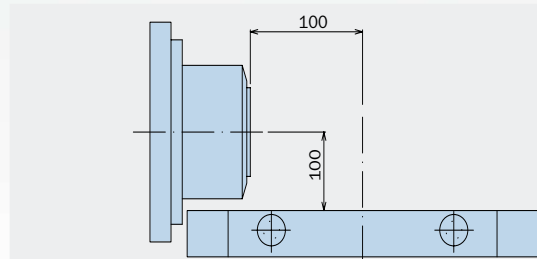
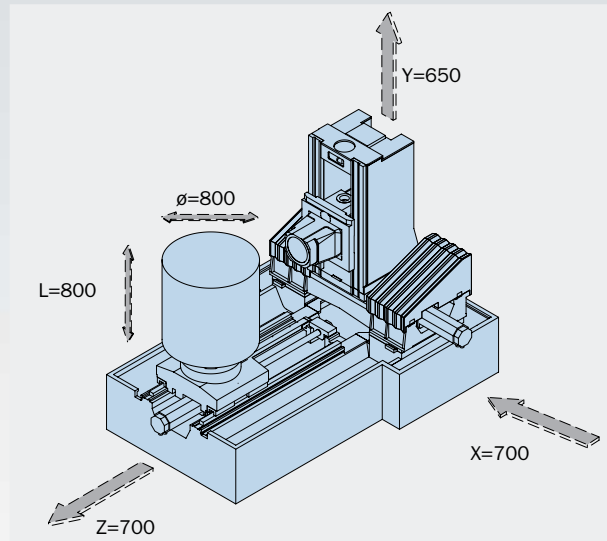

MACHINING CENTERS MANUFACTURING

MCM Spa

I-29020 Vigolzone (PC)
Viale F. e G. Celaschi, 19
Tel. ++39 0523 879901
Fax ++39 0523 879130
E-mail: divcomm@mcmspa.it
http: www.mcmspa.it

MCM FRANCE Sarl

F-91600 Savigny sur Orge
6 Av. du Garigliano
Tel. 01-69-21-21-00
Fax 01-69-24-10-34
E-mail: mcm@mcm-france.com

MCM VERTRIEBS GmbH DEUTSCHLAND

D-65189 Wiesbaden Humboldtstraße, 13
Tel. 0611-372747
Fax 0611-372745
E-mail: rebecca@t-online.de

MCM CANADA

2311- 29th Ave. LAVAL WEST, QC
H7R 3L4 CANADA
Phone (450) 627 1414
Fax (450) 627 7336
E-mail: astefanoni@sympatico.ca

MCM USA Inc.

34525 Melinz Parkway, Suite 208-C
Eastlake, OH 44095 - U.S.A.
Phone (440) 9181415
Fax (440) 9180776
Toll free 877 MCM 5999