

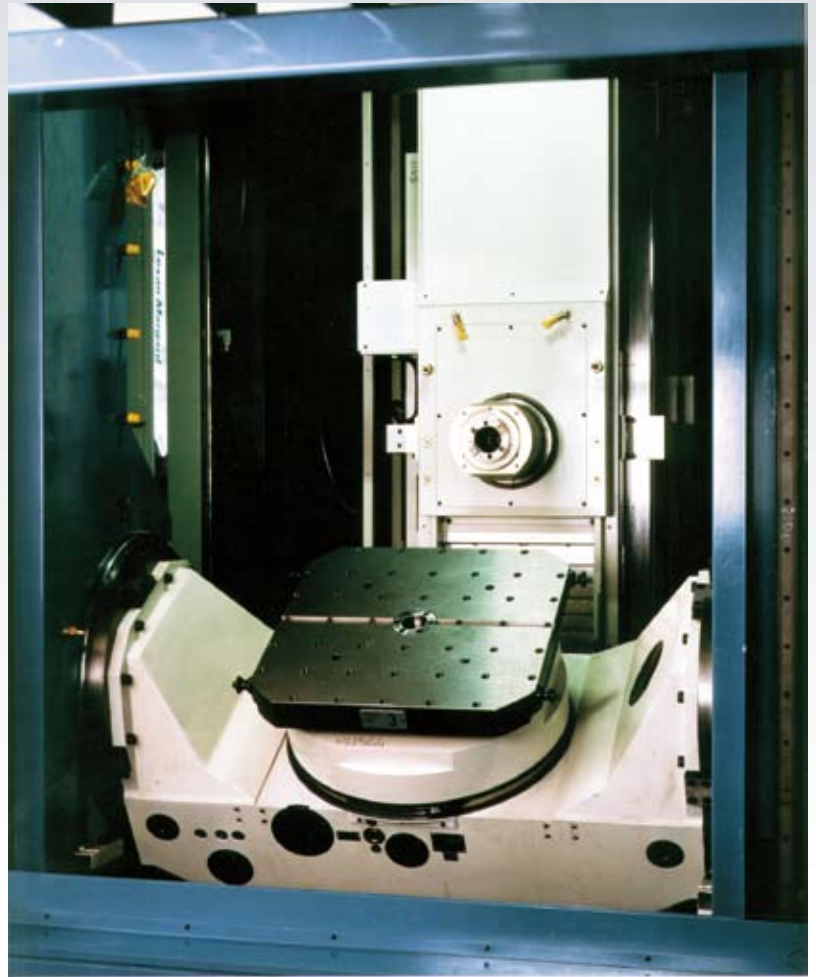

# CLOCK 900 5 AXES T Table

**HSK-A100**  
**Rapid feeds**  
**50 m/min.**  
**Pallet dimensions**  
**630x630/630x800**



|  |                   |
|--|-------------------|
| Tool changing time   | 4 s               |
| Number of tools HSK-A100                                     | 95-999            |
| Tool regeneration + washing + tool check                     | 10 s              |
| Spindle speed  | 8,000 /14,000 rpm |
| Linear axes measuring system with pressurized optical scales |                   |



# CLOCK 900 5 AXES T Table

## TECHNICAL FEATURES

### WORKING AREA

|                                |       |                                       |
|--------------------------------|-------|---------------------------------------|
| Longitudinal X axis            | mm    | 800                                   |
| Vertical Y axis                | mm    | 900                                   |
| Transversal Z axis             | mm    | 1,200                                 |
| Rapid feeds                    | m/min | 50                                    |
| Axes thrust                    | daN   | 2,000                                 |
| Spindle tip-Y pallet distance  | mm    | +240/-5/-105                          |
| Spindle tip-Z pallet distance  | mm    | 100                                   |
| Linear axes measuring system   |       | pressurized Heidenhain optical scales |
| Rotating axes measuring system |       | pressurized Heidenhain encoders       |

AC axes servomotor drive with digital adjustment

### POSITIONING PRECISION IN ACCORDANCE WITH VDI/DGQ 3441 SPECIFICATIONS

#### Linear axes (XYZ)

|                                  |    |   |
|----------------------------------|----|---|
| Positioning precision (Pa)       | µm | 6 |
| Repeatability precision (Ps Med) | µm | 3 |

#### Rotating axes (B-A)

|                                  |        |   |
|----------------------------------|--------|---|
| Positioning precision (Pa)       | arcsec | 6 |
| Repeatability precision (Ps med) | arcsec | 4 |

### SPINDLE TYPE HSK-A100

|                         |      |              |
|-------------------------|------|--------------|
| Tool taper (DIN69893-1) | type | HSK-A100     |
| Rotating speed          | rpm  | 14,000/8,000 |
| Power                   | kW   | 65/25        |
| Max torque              | Nm   | 400/600      |
| Front bearing diameter  | mm   | 110/130      |

### TOOL CHANGE

#### Standard features

|  |    |        |
|--|----|--------|
| Wheel/rack type tool magazine capacity | n. | 95/999 |
| Max. tool length                       | mm | 600    |
| Max tool weight                        | kg | 25     |
| Chip to chip tool changing time        | s  | 10     |
| Max. tool diameter                     | mm | 300    |
| Adjacent tools max. diameter           | mm | 100    |

### TILTING TABLE

|   |            |               |
|---|------------|---------------|
| Pallet dimensions                           | mm         | 630x630       |
|   | mm         | 630x800       |
| Overall fixture rotating diameter           | mm         | 1,050         |
| Tilting angle/Positions                     | degrees/n. | 120/1,200,000 |
| Clamping on 2 supports: side+central cradle |            |               |
| B axis positions                            | n.         | 3,600,000     |
| Max. load on table in vert. position        | kg         | 1,000         |
| Tilting max. torque                         | Nm         | 5,000         |
| Tilting angle compared to horiz. position   | degrees    | +25/-110      |
| B axis rotating speed                       | rpm        | 8             |

### CHIPS CONVEYOR

Scraper type

### COOLANT SYSTEM

1,500 liters tank with self-cleaning filter

### TOTAL WEIGHT (Two pallets version)

kg 30,500

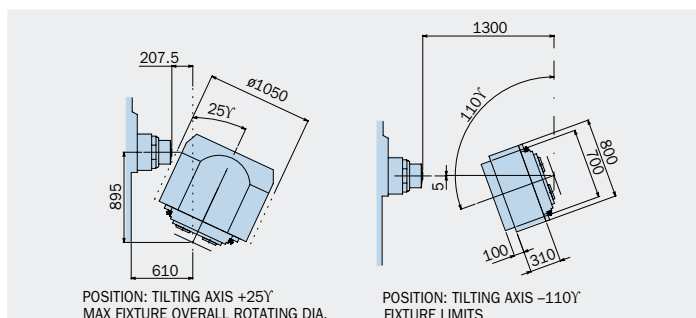
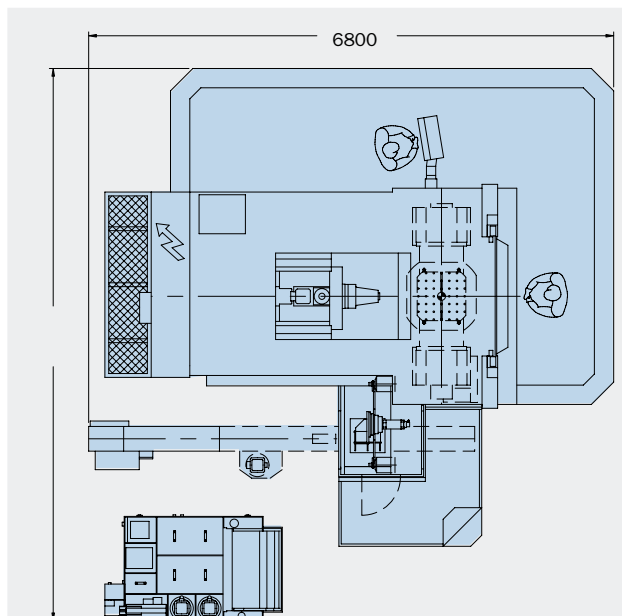
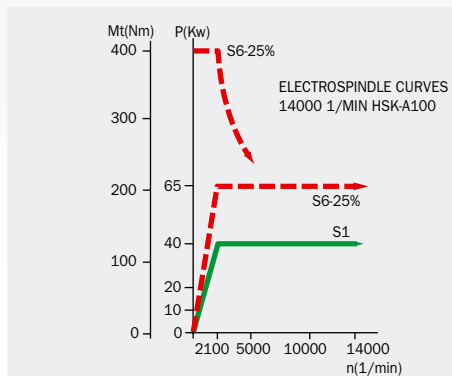
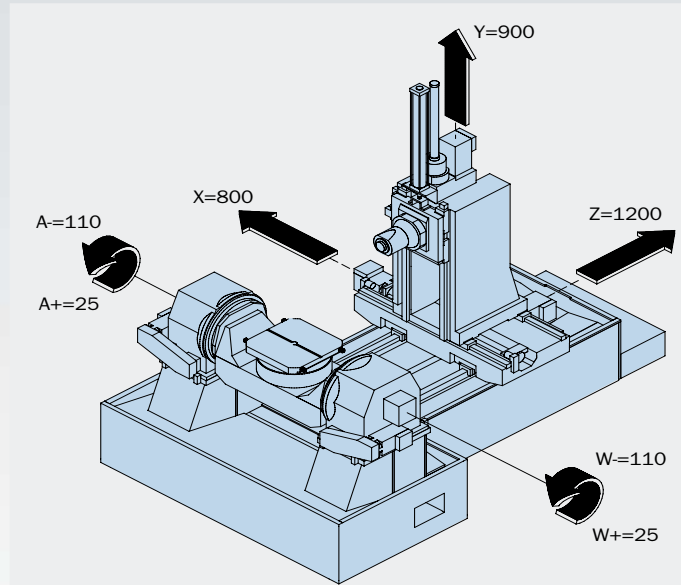

## MACHINING CENTERS MANUFACTURING

### MCM Spa

I-29020 VIGOLZONE (PC)  
Viale F. e G. Celaschi, 19  
Tel. 0523/879901  
Fax 0523/879130  
E-mail: divcomm@mcmspa.it  
www.mcmspa.it

### MCM FRANCE Sarl

F-91600 Savigny sur Orge  
6 Av. du Garigliano  
Tel. 01-69-21-21-00  
Fax 01-69-24-10-34  
E-mail: mcm@mcm-france.com

### MCM VERTRIEBS GmbH

DEUTSCHLAND  
D-65189 Wiesbaden Humboldtstraße, 13  
Tel. 0611-372747  
Fax 0611-372745  
E-mail: rebecchi@t-online.de

### MCM Spa

2311- 29th Ave. LAVAL WEST, QC  
H7R 3L4 CANADA  
Phone (450) 627 1414  
Fax (450) 627 7336  
E-mail: astefanoni@sympatico.ca

### MCM USA Inc.

34525 Melinz Parkway, Suite 208-C  
Eastlake, OH 44095-U.S.A.  
Phone (440) 9181415  
Fax (440) 9180776  
Toll free 877 MCM 5999