

CAPTO C6

Rapid feeds 75 m/min

Pallet dimensions Ø 400

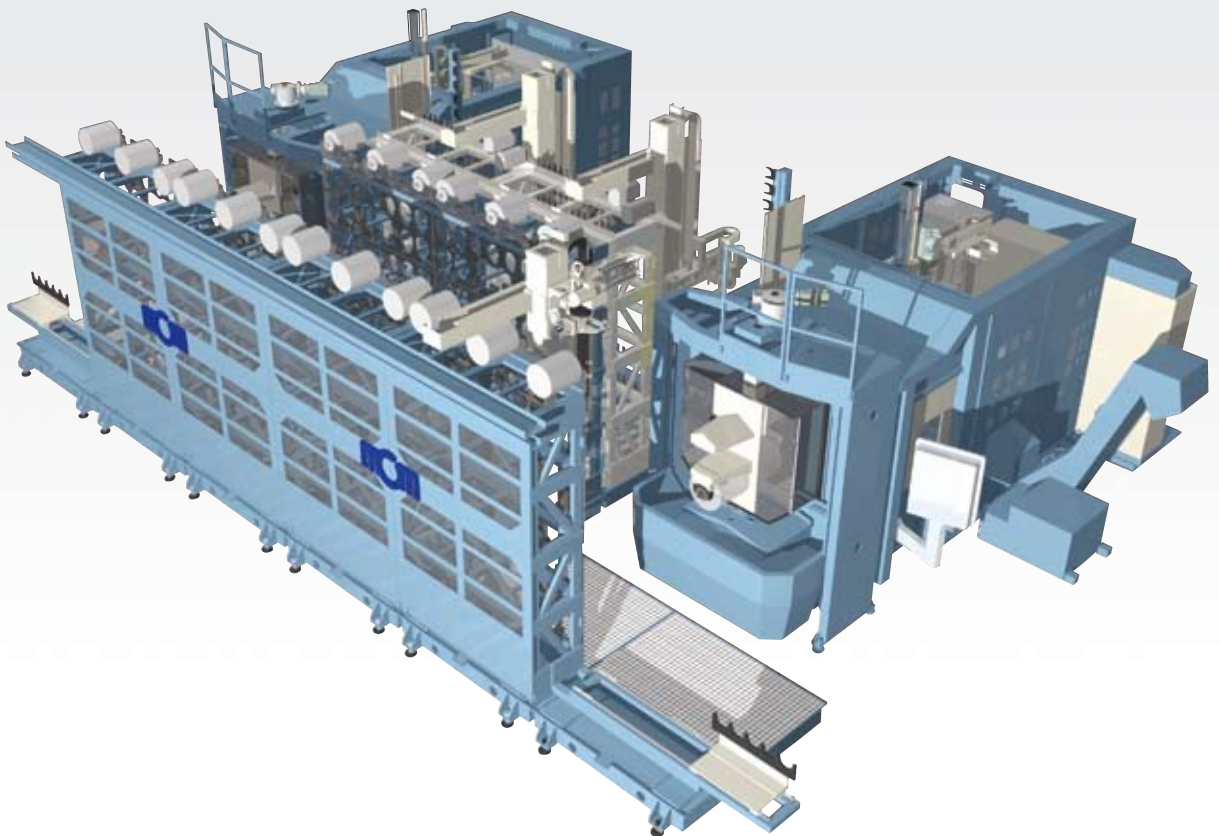

Tool changing time	4,5 s
Number of tools Capto C6	315
Tool regeneration + washing + tool check	7 s
Spindle speed	14.000 rpm
Continuous rotary table	5 Axes



FLEX MULTITASKING 5 Axes

CARATTERISTICHE TECNICHE

TECHNICAL FEATURES

Longitudinal X axis	mm	1.200
Vertical Y axis	mm	850
Transversal Z axis	mm	850
Axes thrust	daN	1.500
Rapid feeds X and Z	mm/min	75.000
Rapid feeds Y	mm/min	60.000

SPINDLE GROUP

Spindle type 14.000 rpm CAPTO C6		
Rotation speed	rpm	14.000
Continuous speed / Max. speed	kW	40/65
Front bearing diameter	mm	110
Continuous torque / Max. torque	Nm	180/400

TOOL CHANGE CAPTO C6

Magazine capacity	n.	315
Max. tool length	mm	340
Max. tool weight	kg	8
Chip to chip tool changing time	s	4,7

PALLET CAPTO C8X

Magazine capacity	n.	159
Max. handling weight	kg	60
Max. handling dimensions (Ø x length)	mm	(Ø) 400x(L)350
Tool changing time	s	25

SPINDLE-CONTINUOUS DIVIDING TABLE TAPER CAPTO C8X

Positions		3.600.000
Rotation speed	rpm	2.000

CHIPS CONVEYOR

Scraper type

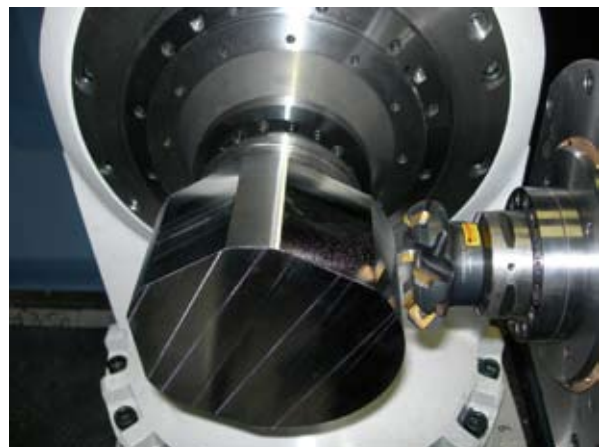
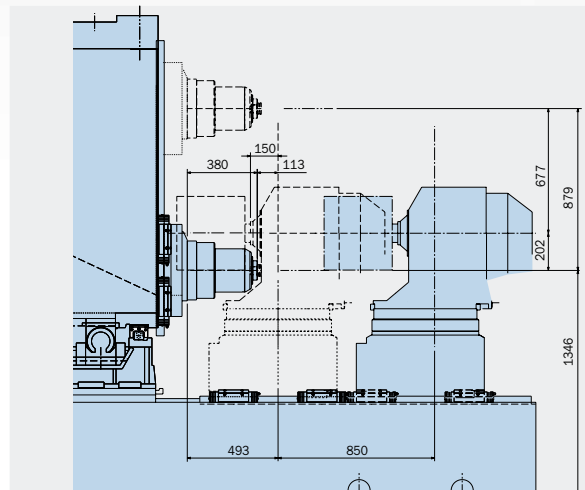
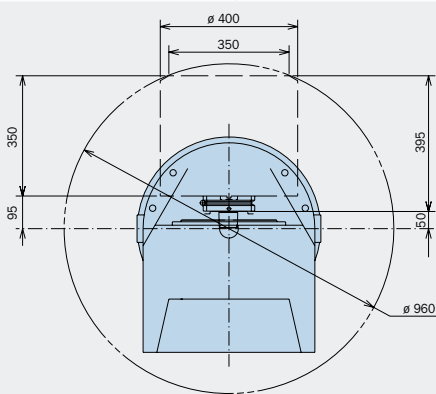

MACHINING CENTERS MANUFACTURING

MCM Spa

I-29020 Vigolzone (PC)
Viale F. e G. Celaschi, 19
Tel. ++39 0523 879901
Fax ++39 0523 879130
E-mail: divcomm@mcmspa.it
http: www.mcmspa.it

MCM FRANCE Sarl

F-91600 Savigny sur Orge
6 Av. du Garigliano
Tel. 01-69-21-21-00
Fax 01-69-24-10-34
E-mail: mcm@mcm-france.com

MCM VERTRIEBS GmbH DEUTSCHLAND

D-65189 Wiesbaden Humboldtstraße, 13
Tel. 0611-372747
Fax 0611-372745
E-mail: rebecchi@t-online.de

MCM CANADA

2311- 29th Ave. LAVAL WEST, QC
H7R 3L4 CANADA
Phone (450) 627 1414
Fax (450) 627 7336
E-mail: astefanoni@sympatico.ca

MCM USA Inc.

34525 Melinz Parkway, Suite 208-C
Eastlake, OH 44095 - U.S.A.
Phone (440) 9181415
Fax (440) 9180776
Toll free 877 MCM 5999