



FORERUNNER 700

HSK-A63

Rapid feeds 120 m/min.

**Pallet dimensions
500x500**

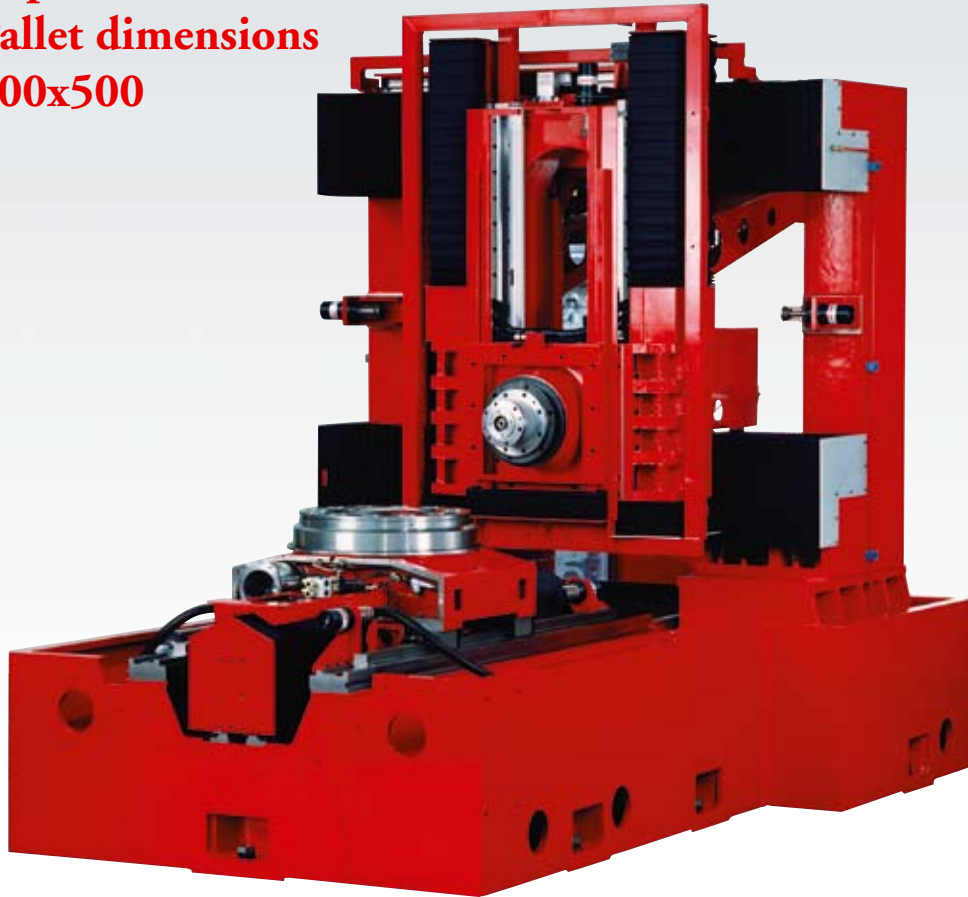

Tool changing time	0.6 s
Number of tools HSK-A63	95-1367
Tool regeneration+washing+tool check	10 s
Spindle speed	24,000 rpm
Continuous rotary table	
Linear axes measuring system with pressurized optical scales	



FORERUNNER 700

TECHNICAL FEATURES

WORKING AREA

Longitudinal X axis	mm	650
Vertical Y axis	mm	600
Transversal Z axis	mm	670
Rapid feeds	m/min	120
Y axis acceleration	m/s ²	20
X-Z axes acceleration	m/s ²	15
Axes thrust	daN	2,000
Spindle tip-Y pallet distance	mm	100
Spindle tip-Z pallet distance	mm	120
Linear axes measuring system	pressurized Heidenhain optical scales	
Rotating axes measuring system	pressurized Heidenhain encoders	
AC axes servomotor drive with digital adjustment		

POSITIONING PRECISION IN ACCORDANCE WITH VDI/DGQ 3441 SPECIFICATIONS

Linear axes (XYZ)

Positioning precision (Pa)	µm	5
Repeatability precision (Ps Med)	µm	3

Rotating axes (B)

Positioning precision (Pa)	arcsec	6
Repeatability precision (Ps med)	arcsec	4

SPINDLE TYPE HSK-A63

Tool taper (DIN69893-1)	type	HSK-A63
Rotating speed	rpm	24,000
Power	kW	50
Max torque	Nm	150
Front bearing diameter	mm	85

TOOL CHANGE

Standard features		
Wheel/rack type tool magazine capacity	n.	125/1367 HSK-A63
Max. tool length	mm	300
Max tool weight	kg	8
Chip to chip tool changing time	s	3
Max. tool diameter	mm	200
Adjacent tools max. diameter	mm	65

PALLET CHANGER

Pallet changing time	s	6
Number of pallets	n.	2
Pallet dimensions	mm	500x500
Overall rotating diameter	mm	750
Max. load for pallet	kg	200

CONTINUOUS ROTARY TABLE

Positions	n.	3,600,000
Speed rotation	rpm	65

CHIPS CONVEYOR

Scrapers type

COOLANT SYSTEM

750 liters tank with self-cleaning filter

TOTAL WEIGHT (Two pallets version)

kg 18,800

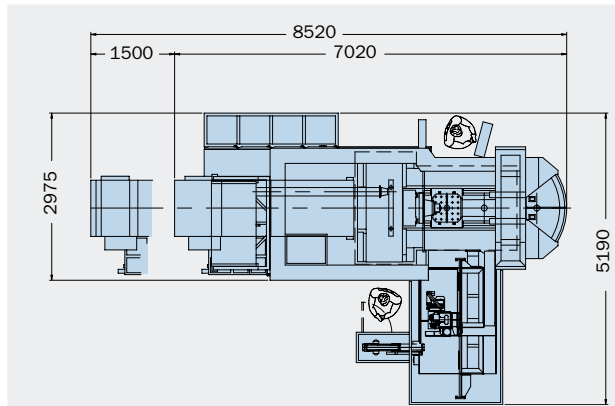
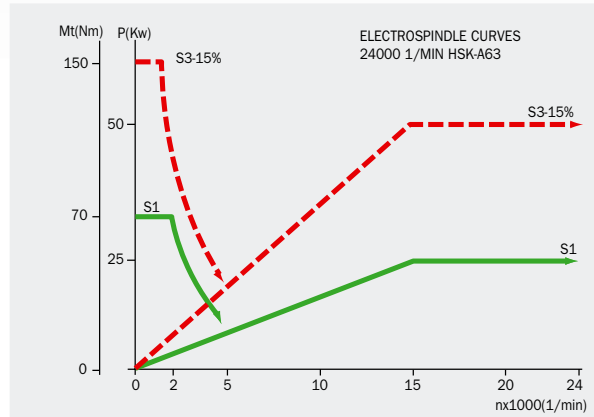
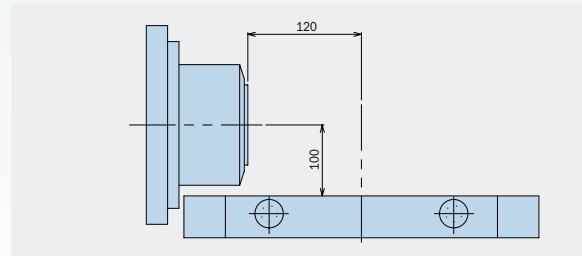
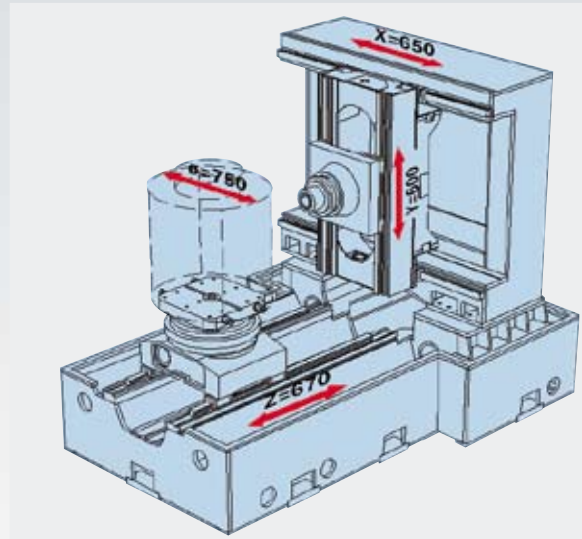

MACHINING CENTERS MANUFACTURING

MCM Spa

I-29020 Vigolzone (PC)
Viale F. e G. Celaschi, 19
Tel. ++39 0523 879901
Fax ++39 0523 879130
E-mail: divcomm@mcmspa.it
http: www.mcmspa.it

MCM FRANCE Sarl

F-91600 Savigny sur Orge
6 Av. du Garigliano
Tel. 01-69-21-21-00
Fax 01-69-24-10-34
E-mail: mcm@mcm-france.com

MCM VERTRIEBS GmbH DEUTSCHLAND

D-65189 Wiesbaden Humboldtstraße, 13
Tel. 0611-372747
Fax 0611-372745
E-mail: rebecchi@t-online.de

MCM CANADA

2311- 29th Ave. LAVAL WEST, QC
H7R 3L4 CANADA
Phone (450) 627 1414
Fax (450) 627 7336
E-mail: astefanoni@sympatico.ca

MCM USA Inc.

34525 Melinz Parkway, Suite 208-C
Eastlake, OH 44095 - U.S.A.
Phone (440) 9181415
Fax (440) 9180776
Toll free 877 MCM 5999